

F

E

D

C

B

A

RoHS
Compliant

SYMBOL

REVISION

APPROVAL

DATE

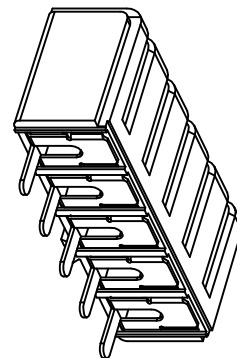
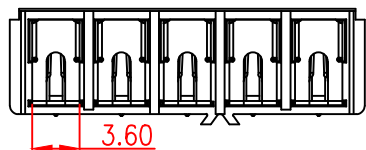
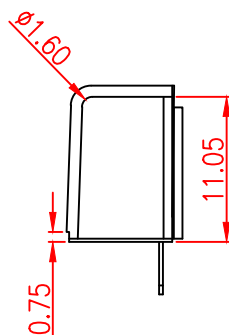
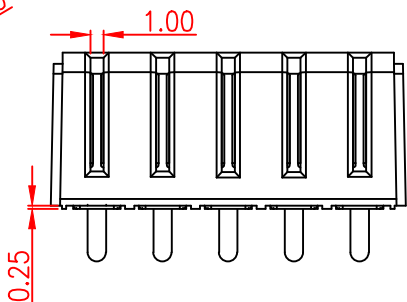
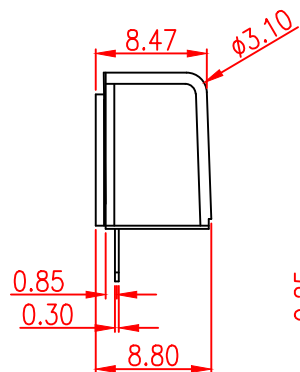
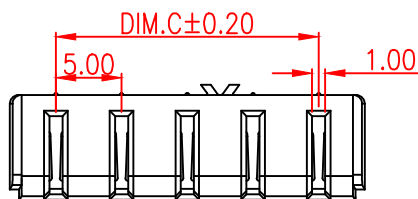
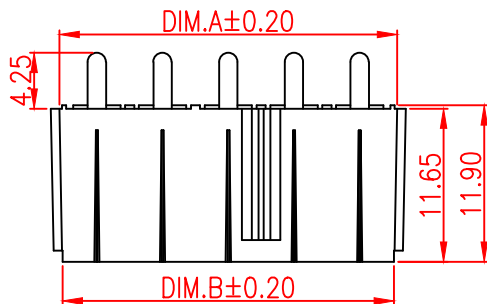

备注:

1. 产品规格:

1-1. 额定电压:30V

1-2. 耐电压:1000V AC MIN.

1-3. 接触阻抗:30mΩ MAX. INITIAL;40mΩ MAX
AFTER 3000 CYCLES

1-4. 绝缘电阻:1000MΩ MIN

1-5. 工作温度:-25°C TO +80°C

2. 材质:

2.1胶芯: PA9T UL94V-0/LCP BLACK

2.2端子: 合金铜, 镍底, GOLD

3. 所用材质须符合RoHS要求

PART NUMBER	PIN	Dim.A	Dim.B	Dim.C
ND-Z01F-2Pin-S1	02pin	10.70	10.20	5.00
ND-Z01F-3Pin-S1	03pin	15.70	15.20	10.00
ND-Z01F-4Pin-S1	04pin	20.70	20.20	15.00
ND-Z01F-5Pin-S1	05pin	25.70	25.20	20.00

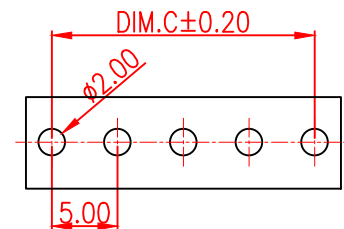

RECOMMENDED P.C.BOARD LAYOUT

广东诺德电子科技有限公司

COPYRIGHT RESERVED,PLEASE DO NOT COPY.

PART NAME

CONNECTOR

DRAWING

M.M.Zhang

DWG.No.

JD-009

PART NO.

ND-Z01F-S1 系列

CHECK

G.C.Chen

REV.

A1

UNIT :
mmTOLERANCE
OTHERWISEUP TO 5 ±0.2
ABOVE 5~30 ±0.3
ABOVE 30 ±0.5
ANGLE ±3°ANGLE
0°±3°

APPROVAL

SCALE

DATE

01-07-2016

2:1

PAGE

1 OF 1

F

E

D

C

B

A